

SERVICE PARTS KIT LIST

2100 SERIES

FLOJET®

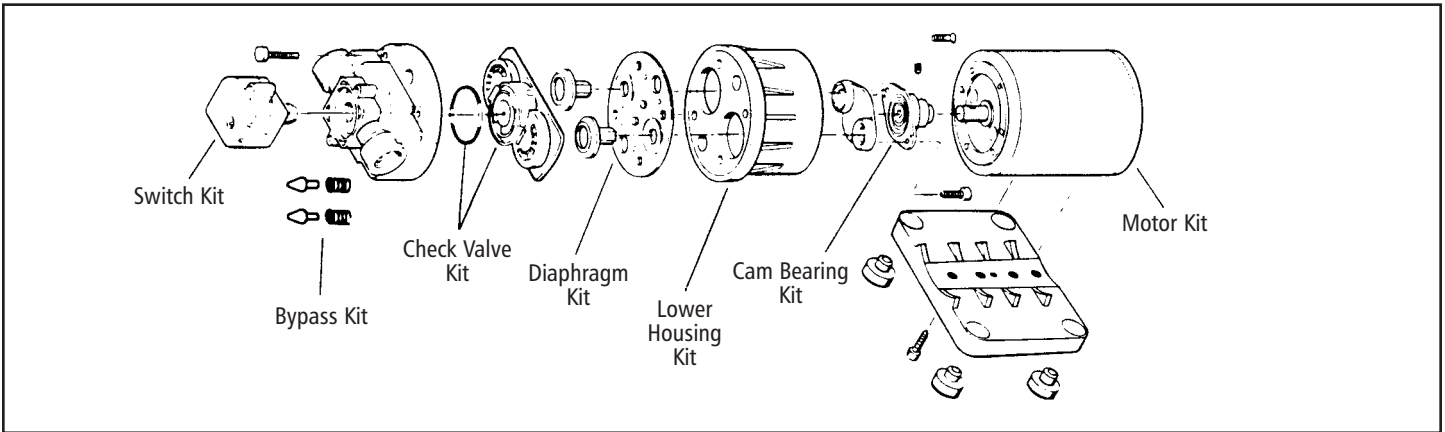

PARTS KIT DESCRIPTIONS

Switch Kit:
Complete pressure switch with wire leads.



Bypass Kit:
Bypass poppets and springs, two each.

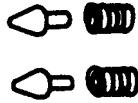

Diaphragm Kit:
Diaphragm with inner and outer pistons and screws.

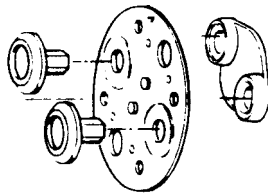

Motor Kit:
Complete motor assembly.

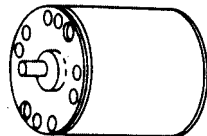

Check Valve Kit:
Check valve assembly with "O" ring.

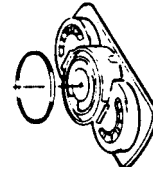

Cam/Bearing Kit:
Cam/bearing assembly with screw.



Lower Housing Kit:
Lower housing with cam, diaphragm and piston assembly.

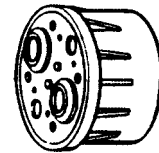

To find correct parts kits: Identify the pump model number in the left column and read across to the kit number required. If pump has a switch and bypass, both are shown in the second column. Complete service kits, available for some models, are shown in the right column. Service Kits include Bypass Kit (where used), Check Valve, Diaphragm and Cam/Bearing Kits.

For individual parts not included in this list, please refer to your installation, operation and service instruction sheet for the particular pump model.

 **ITT**
Engineered for life

2100 SERIES PARTS KIT LIST

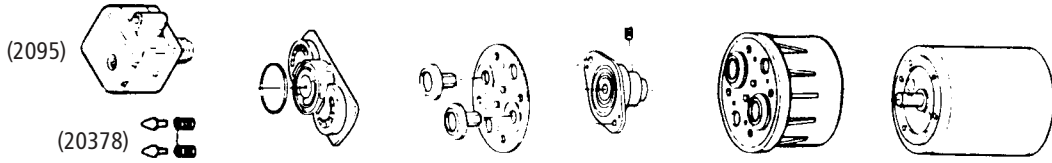

Model #	Switch Bypass Kit	Check Valve Assy Kit	Cam Bearing Diaphragm Kit	Lower Hsg Kit	Motor
2100-012	02090-100	20914-001A	21004-202	21022-012A	02029-000
2100-020	02090-100	20914-002A	21004-100	21022-020A	02029-000
2100-021	02090-100	20914-002A	21004-101	21022-021A	02029-000
2100-022	02090-100	20914-002A	21004-102	21022-022A	02029-000
2100-024	02090-100	20914-002A	21004-104	21022-024A	02029-000
2100-030	02090-100	20914-003A	21004-420	21022-040A	02029-000
2100-031	02090-100	20914-003A	21004-421	21022-041A	02029-000
2100-032	02090-100	20914-003A	21004-402	21022-042A	02029-000
2100-034	02090-100	20914-003A	21004-404	21022-044A	02029-000
2100-035	02090-100	20914-003A	21004-405	21022-045A	02029-026
2100-112	02090-100	20914-001A	21004-202	21022-012A	02009-004
2100-120	02090-100	20914-002A	21004-100	21022-020A	02009-004
2100-121	02090-100	20914-002A	21004-101	21022-021A	02009-004
2100-122	02090-100	20914-002A	21004-102	21022-022A	02009-004
2100-124	02090-100	20914-002A	21004-104	21022-024A	02009-004
2100-130	02090-100	20914-003A	21004-400	21022-040A	02009-004
2100-131	02090-100	20914-003A	21004-401	21022-041A	02009-004
2100-132	02090-100	20914-003A	21004-402	21022-042A	02009-004
2100-134	02090-100	20914-003A	21004-404	21022-044A	02009-004
2100-135	02090-100	20914-003A	21004-405	21022-045A	02009-015
2100-212	02090-100	20914-001A	21004-202	21022-012A	02039-001
2100-222	02090-100	20914-002A	21004-102	21022-022A	02039-001
2100-230	02090-100	20914-003A	21004-400	21022-040A	02039-001
2100-231	02090-100	20914-003A	21004-401	21022-041A	02039-001
2100-232	02090-100	20914-003A	21004-402	21022-042A	02039-001
2100-234	02090-100	20914-003A	21004-404	21022-044A	02039-001
2100-235	02090-100	20914-003A	21004-405	21022-045A	02039-031
2100-311	02090-100	20914-001A	21004-201	21022-011A	02019-001
2100-312	02090-100	20914-001A	21004-202	21022-112A	02019-001
2100-331	02090-100	20914-003A	21004-401	21022-041A	02019-001
2100-332	02090-100	20914-003A	21004-402	21022-042A	02019-001
2100-503	02090-100	20914-002A	21004-200	21022-040A	02029-000
2100-515	N/A	20914-003A	21004-402	21022-042A	02029-000
2100-535	N/A	20914-003A	21004-405	21022-045A	02029-015
2100-544	02090-100	20914-003A	21004-401	21022-041A	02039-005
2100-549	02378-001	20028-061	21004-300	21022-030A	02029-000
2100-551	02090-100	20914-003A	21004-400	21022-040A	02029-009
2100-553	20378-001	20028-001	21004-400	21022-041A	02039-008
2100-556	20378-001	20028-002	21004-400	21022-040A	02039-073
2100-561	N/A	20914-003A	21004-402	21022-042A	02039-023
2100-571	20373-003	20028-022	21004-205	21022-015A	02049-013
2100-573	N/A	20914-003A	21004-402	21022-042A	02009-004
2100-576	N/A	20914-003A	21004-404	21022-044A	02039-001
2100-579	20378-001	20028-002	21004-400	21022-040A	02009-004

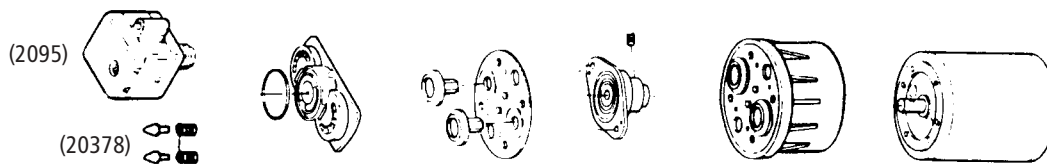

Model #	Switch Bypass Kit	Check Valve Assy Kit	Cam Bearing Diaphragm Kit	Lower Hsg Kit	Motor
2100-591	02090-100	20914-003A	21004-400	21022-040A	02039-001
2100-592	20378-001	20028-012	21004-204	21022-014A	02029-000
2100-597	N/A	20914-002A	21004-221	21022-011A	02009-004
2100-598	02090-100	20914-002A	21004-220	21022-010A	02039-001
2100-599	02090-100	20914-002A	21004-400	21022-040A	02009-004
2100-609	20378-001	20028-048	21004-404	21022-044A	02009-004
2100-610	N/A	20914-001A	21004-202	21022-012A	02009-004
2100-615	N/A	20914-003A	21004-402	21022-042A	02009-004
2100-629	20378-001	20028-048	21004-404	21022-044A	02039-001
2100-636	N/A	20914-003A	21004-402	21022-042A	02009-025
2100-637	N/A	20914-003A	21004-402	21022-042A	02009-002
2100-773	02090-100	20914-002A	21004-101	21022-021A	02029-000
2100-777	02090-100	20914-002A	21004-400	21022-040A	02009-004
2100-779	02090-100	20914-002A	21004-404	21022-044A	02049-001
2100-780	02037-8001	20028-045	21004-300	21022-130A	02029-000
2100-782	N/A	201914-001A	21004-205	21022-015A	02029-096
2100-783	N/A	201914-003A	21004-404	21022-044A	02039-091
2100-789	02090-100	201914-002A	21004-402	21022-042A	02049-001
2100-790	N/A	201914-002A	21004-402	21022-042A	02029-000
2100-792	N/A	201914-002A	21004-100	21022-020A	02029-000
2100-802	02090-100	201914-002A	21004-104	21022-024A	02009-071
2100-803	N/A	201914-003A	21004-401	21022-041A	02009-004
2100-815	N/A	201914-001A	21004-220	21022-010A	02029-000
2100-822	02090-100	201914-002A	21004-102	21022-022A	02009-015
2100-825	20357-005	20028-080	21004-121	21022-021A	02039-008
2100-831	20378-001	20028-078	21004-402	21022-042A	02009-004
2100-835	20378-003	20028-078	21004-402	21022-042A	02009-015
2100-840	20378-012	20028-022	21004-202	21022-012A	02009-015
2100-848	N/A	20914-002A	21004-402	21022-042A	02009-015
2100-851	20378-002	20028-003	21004-401	21022-041A	02029-000
2100-855	20378-001	20028-078	21004-102	21022-022A	02029-000
2100-856	02090-104	20914-002A	21004-202	21022-012A	02029-000
2100-858	02090-100	20914-003A	21004-402	21022-042A	02029-000
2100-859	02090-103	20914-003A	21004-302	21022-032A	02039-001
2100-869	N/A	20914-001A	21004-202	21022-112A	02009-015
2100-871	N/A	20914-003A	21004-402	21022-042A	02029-000
2100-872	20378-003	20028-022	21004-202	21022-012A	02049-018
2100-877	20378-000	20028-028	21004-204	21022-014A	02039-001
2100-882	20378-003	20028-003	21004-400	21022-040A	02029-068
2100-883	20378-003	20028-003	21004-400	21022-040A	02039-001
2100-884	20378-001	20028-003	21004-402	21022-042A	02009-015
2100-888	20378-000	20028-022	21004-202	21022-012A	02009-015
2100-894	N/A	20028-078	21004-202	21022-012A	02009-004
2100-895	N/A	20194-003A	21004-400	21022-040A	02019-001
2100-899	N/A	20194-003A	21004-402	21022-042A	02029-031

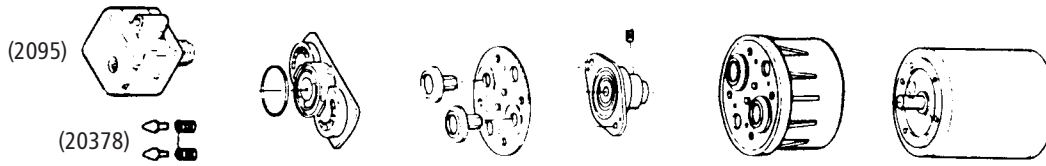

Model #	Switch Bypass Kit	Check Valve Assy Kit	Cam Bearing Diaphragm Kit	Lower Hsg Kit	Motor
2100-901	20378-001	20028-078	21004-102	21022-022A	02009-004
2100-902	N/A	20194-001A	21004-204	21022-014A	02009-004
2100-904	N/A	20194-002A	21004-200	21022-010A	02009-004
2100-907	20378-001	20028-078	21004-202	21022-012A	02009-004
2100-910	N/A	20194-001A	21004-201	21022-011A	02009-015
2100-914	20378-002	20028-008	21004-202	21022-012A	02029-000
2100-929	20378-011	20028-011	21004-400	21022-042A	02029-013
2100-931	N/A	20194-001A	21004-202	21022-012A	02019-013
2100-942	02090-100	20194-003A	21004-405	21022-045A	02009-015
2100-943	02090-103	20194-004A	21004-301	21022-031A	02009-004
2100-945	02090-100	20194-003A	21004-402	21022-042A	02029-000
2100-947	N/A	20194-003A	21004-400	21022-040A	02039-001
2100-959	20378-003	20028-045	21004-400	21022-040A	02009-061
2100-971	02090-103	20194-003A	21004-402	21022-042A	02029-014
2100-972	20378-003	20028-078	21004-202	21022-112A	02009-063
2100-973	20378-004	20028-003	21004-402	21022-042A	02029-072
2100-974	20378-001	20028-002	21004-400	21022-040A	02029-031
2100-978	02090-100	20194-003A	21004-402	21022-042A	02039-001
2100-979	20378-003	20028-003	21004-400	21022-040A	02029-074
2100-983	20378-001	20028-022	21004-202	21022-012A	02009-068
2100-984	20378-002	20028-078	21004-402	21022-042A	02009-043
2100-987	02090-119	20194-002A	21004-201	21022-011A	02009-070
2100-996	02090-117	20194-002A	21004-122	21022-022A	02039-023

www.flojet.com

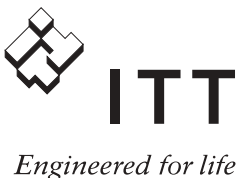

USA

Jabscos
Cape Ann Industrial Park
1 Kondelin Road
Gloucester, MA 01930
Tel: +1 976 281 0440
Fax: +1 976 283 2619

UK

Jabscos
Bingley Road, Hoddesdon
Hertfordshire EN 11 0BU
Tel: +44 1992 450145
Fax: +44 1992 467132

CANADA

Fluid Products Canada
55 Royal Road
Guelph, Ontario N1H 1T1
Tel: +1 519 821 1900
Fax: +1 519 821 5316

JAPAN

NHK Jabscos Co Ltd.
3-21-10, Shin-Yokohama
Kohoku-ku
Yokohama 222-0033
Tel: +81 045 475 8906
Fax: +81 045 477 1162

GERMANY

Jabscos GmbH
OststraBe 28
22844 Norderstedt
Tel: +49 40 5353 730
Fax: +49 40 5353 7311

ITALY

Jabscos Marine Italia
Via Tommaseo, 6
20059 Vimercate, Milano
Tel: +39 039 685 2323
Fax: +39 039 666 307